

NOTES

- FOR STANDARD NOTES REFER TO DRAWING No. CD000.
- THIS DRAWING IS TO BE READ IN CONJUNCTION WITH ALL RELEVANT ARCHITECTURAL SERVICES & M.E.A. DRAWINGS.
- ALL DIMENSIONS ARE IN MILLIMETRES UNLESS OTHERWISE NOTED. LEVELS ARE STRUCTURAL LEVELS IN METRES TO ORDINANCE DATUM. THIS DRAWING MUST NOT BE SCALED.

NOTE:

- MINOR EMISSION POINTS
- POTENTIAL EMISSION POINTS

LEGEND:

- A3-1 BOILER BLOW DOWN TANK
- A3-2 HVAC EXHAUST 1
- A3-3 HVAC EXHAUST 2
- A3-4 SCRUBBER SOLIDIFICATION PLANT
- A3-5 HVAC EXHAUST 3
- A3-6 ODOUR MANAGEMENT SYSTEM FOR BUNKER DURING SHUTDOWNS
- A3-7 AIR COMPRESSOR 1
- A3-8 AIR COMPRESSOR 2
- A3-9 AIR COMPRESSOR 3
- A3-10 DIESEL TANK FIRE WATER PUMP 1
- A3-11 DIESEL TANK FIRE WATER PUMP 2
- A3-12 DIESEL TANK FIRE WATER PUMP 3
- A3-13 DIESEL TANK VENT
- A3-14 EXTRACTION LAB FUME HOODS
- A3-15 EXTRACTION WELDING BOOTH
- A3-16 BOILER START UP VALVE
- A3-17 DESLAGGER EXTRACTION
- A4-1 DIESEL GENERATOR
- A4-2 FIRE WATER PUMP 1
- A4-3 FIRE WATER PUMP 2
- A4-4 FIRE WATER PUMP 3
- A4-5 AQUEOUS WASTE STORAGE TANK SAFETY VALVE
- A4-6 AMMONIA STORAGE TANK SAFETY VALVE
- A4-7 DIESEL STORAGE TANK SAFETY VALVE
- A4-8 AIR CONDENSER SAFETY VALVE 1
- A4-9 AIR CONDENSER SAFETY VALVE 2
- A4-10 AIR CONDENSER RUPTURE DISK 1
- A4-11 AIR CONDENSER RUPTURE DISK 2
- A4-12 BOILER MAIN SAFETY
- A4-13 BOILER DRUM SAFETY
- A4-14 HIGH PRESSURE STREAM HEADER
- A4-15 BOILER FEEDWATER SAFETY 1
- A4-16 BOILER FEEDWATER SAFETY 2

— AREA TO WHICH APPLICATION RELATES OUTLINED IN RED

E	ISSUED FOR INFORMATION	E ON	JMD	24.06.2019
D	ISSUED FOR INFORMATION	E ON	JMD	21.06.2019
C	ISSUED FOR INFORMATION	E ON	JMD	10.06.2019
B	ISSUED FOR INFORMATION	E ON	JMD	07.06.2019
A	ISSUED FOR COMMENT	E ON	JMD	30.05.2019
REV.	DESCRIPTION	BY	APPR.	DATE

THIS DOCUMENT IS COPYRIGHT AND THE PROPERTY OF MCELROY ASSOCIATES. THIS DOCUMENT IS NOT TO BE REPRODUCED, COPIED OR RELEASED IN PART OR IN WHOLE TO ANY OTHER PERSON OR ORGANIZATION WITHOUT THE PRIOR WRITTEN PERMISSION OF MCELROY ASSOCIATES.

MFA McElroy Associates
ENGINEERS TO INDUSTRY

72 Hardington Road, Ballsbridge, D4. Tel: 660 9000 E-Mail: info@mea.ie Web: www.mea.ie

CLIENT:
INDAVER

PROJECT:
INDAVER RINGASKIDDY

TITLE:
MINOR EMISSION POINTS

DESIGNED:	CHECKED:	APPROD:
PS	PS	PS
DRAWN:	DATE:	SCALE:
E ON	MAY 19	AS SHOWN @ A3

DRG. No.	28059CD5006	REV.	E
----------	-------------	------	---

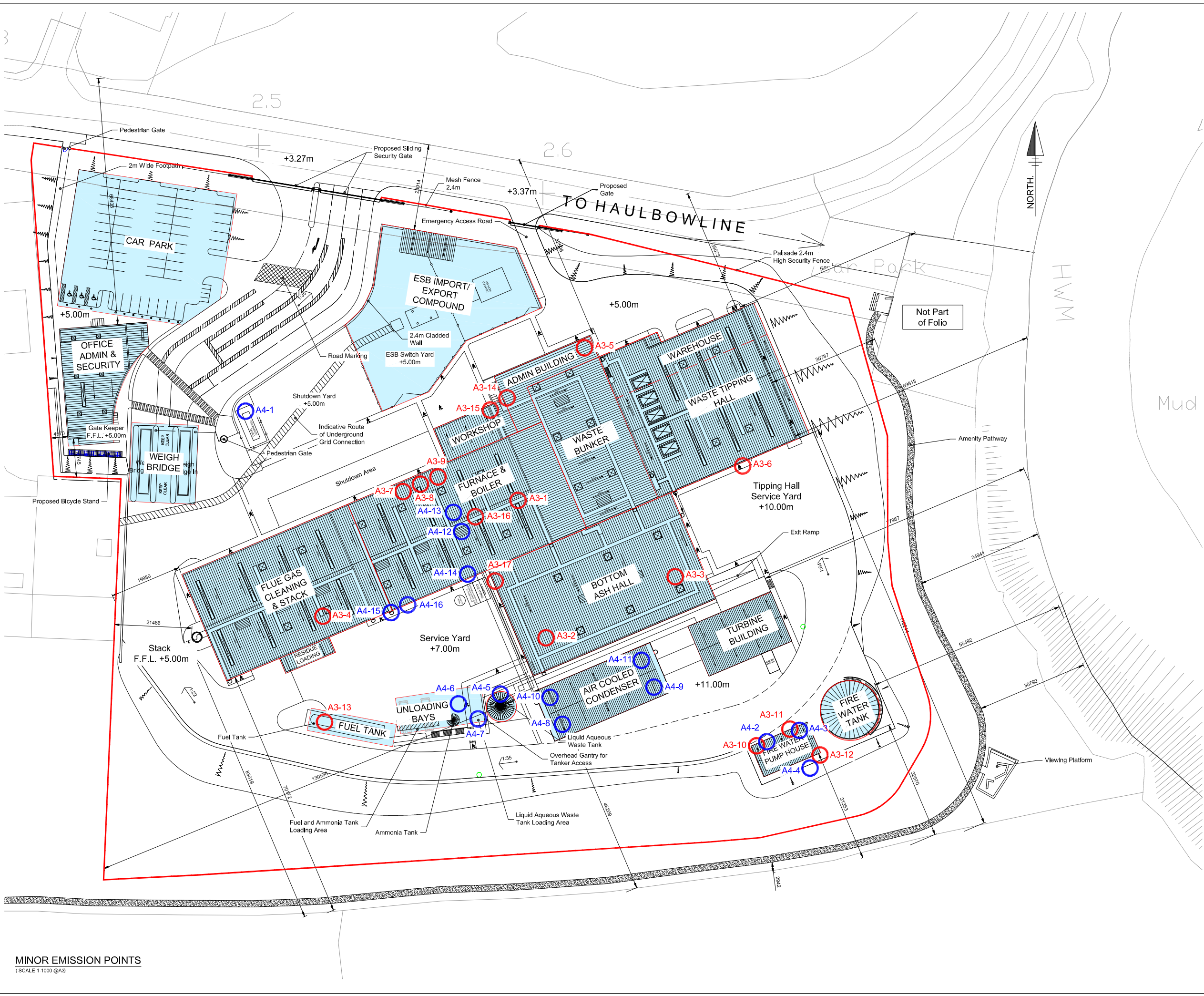

MINOR EMISSION POINTS
(SCALE 1:1000 @A3)